

ZJI RigidFlex XL Entry Fittings - Installation Instructions

(for Flat or Curved Single-Wall Sumps)

STEP 1

Drill a hole in the sump wall large enough for the pipe to pass through. The RigidFlex XL fitting is designed for 6" and 8" pipe sizes, with 6.6"/6.8" and 8.8" OD respectively. Hole saw blades are available from ZJI

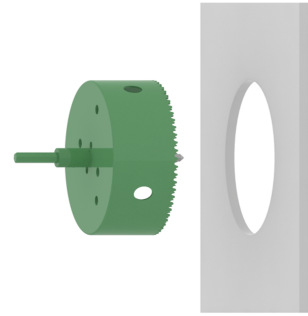

STEP 2

Using one of the hard poly rings as a guide (supplied in fitting kit), mark and then drill the bolt hole pattern in the sump wall with a 1/4" drill bit.

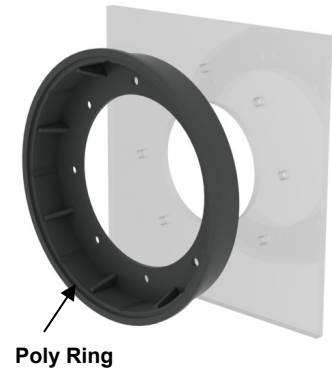

STEP 3

Apply a liberal bead of fitting sealant to the back of both the interior and exterior gasket portions of the fitting. Use the molded ribs as a guide for sealant placement, making sure that there is adequate sealant around the bolt holes.

When the gaskets are compressed to the sump wall, sealant should be visible at the edge of the gasket.

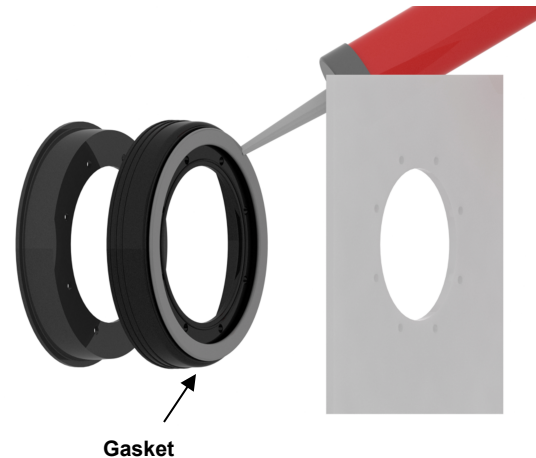

STEP 4

Align both interior and exterior poly rings with the gaskets and install bolts and lock nuts.

NOTE: If installing to a "curved wall" surface, use the curved wall gasket and make sure that it is rotated to properly fit the curvature of the sump.

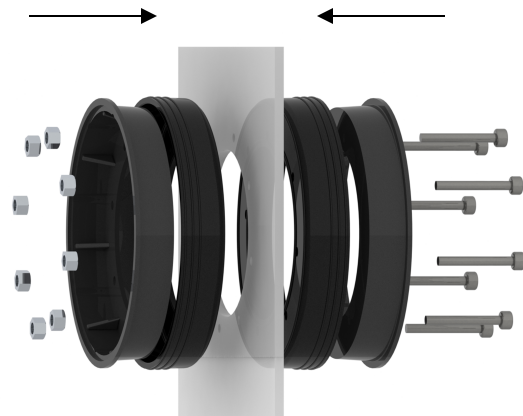

ZJI RigidFlex XL Entry Fittings - Installation Instructions

(for Flat or Curved Single-Wall Sumps)

STEP 5

Working in a “star” pattern to keep the assembly flat and flush with the sump wall, tighten all nuts until snug.



STEP 6

Place the interior and exterior fitting boot over the interior and exterior gasket rings. Tighten the large band clamps until snug to secure the boot to the gasket ring.

NOTE: It is highly recommended, but not required, that you apply a liberal coating of FastFuse bonding solvent around the entire side of the gaskets immediately before installing the interior and exterior fitting boots onto the gaskets. No cure time required before moving to next steps. Simply tighten the band clamps down snugly.



STEP 7

Install pipe through the fittings and when secured in place tighten band clamps over the mouth of the boot securely to provide a seal on the pipe. A slight amount of fitting sealant can be wiped onto the surface of the pipe where the fitting seals onto the pipe to assure that any micro-grooves are covered making a very good seal. Unless the fitting has been specified for a filler, the installation is now completed and ready for testing.



STEP 8

If the fitting has been ordered with Fill Tubes, then apply the FastFill filler material at this time. Make sure that the vent tube is at the 12:00 position. Fill until material exits vent tube. Testing can be attempted within 15 minutes of the completion of this process.

